

Black Rock NCA Administrative Facility Summary

An Administrative Facility would be developed on two acres of public land approximately 0.8 miles northwest of Gerlach, Nevada in Washoe County. The facility would be located in Township 32 North, Range 23 East Section 15: Lot 2, MDM. See Map at right and site plan on reverse.

The Administrative Facility would include the following components:

- An office/visitor services building containing:
 - o Approximately 400 ft² for a visitor center.
 - o Approximately 1,300 ft² of office and work space.
- A 2,000 ft² bunkhouse building including:
 - o Common use kitchen area
 - o Common use dining area/living room.
 - o Six to eight small bedrooms.
 - o Two full bathrooms.
- An 1,800 ft² warehouse/shop/storage building including:
 - o Storage shelving
 - o Work spaces
 - o Rollup doors allow vehicles to access the building
 - o Attached, covered fire engine parking
- A chain link perimeter fence that would enclose the “official use” portions of the facility.
 - o Outdoor materials storage
 - o Pens for holding horses
 - o RV hookups
- Parking would be available for oversized RVs and vehicles towing trailers.

Development of the facility would require the granting of several rights-of-way for utilities and access, issuing a Free Use Permit for gravel from an existing pit and would require acquisition of one access easement.

The facility is being funded through the American Recovery and Reinvestment Act of 2009 (commonly known as the Stimulus Act).

The facility was identified in the 2004 Resource Management Plan for the Black Rock Desert-High Rock Canyon Emigrant Trails National Conservation Area.

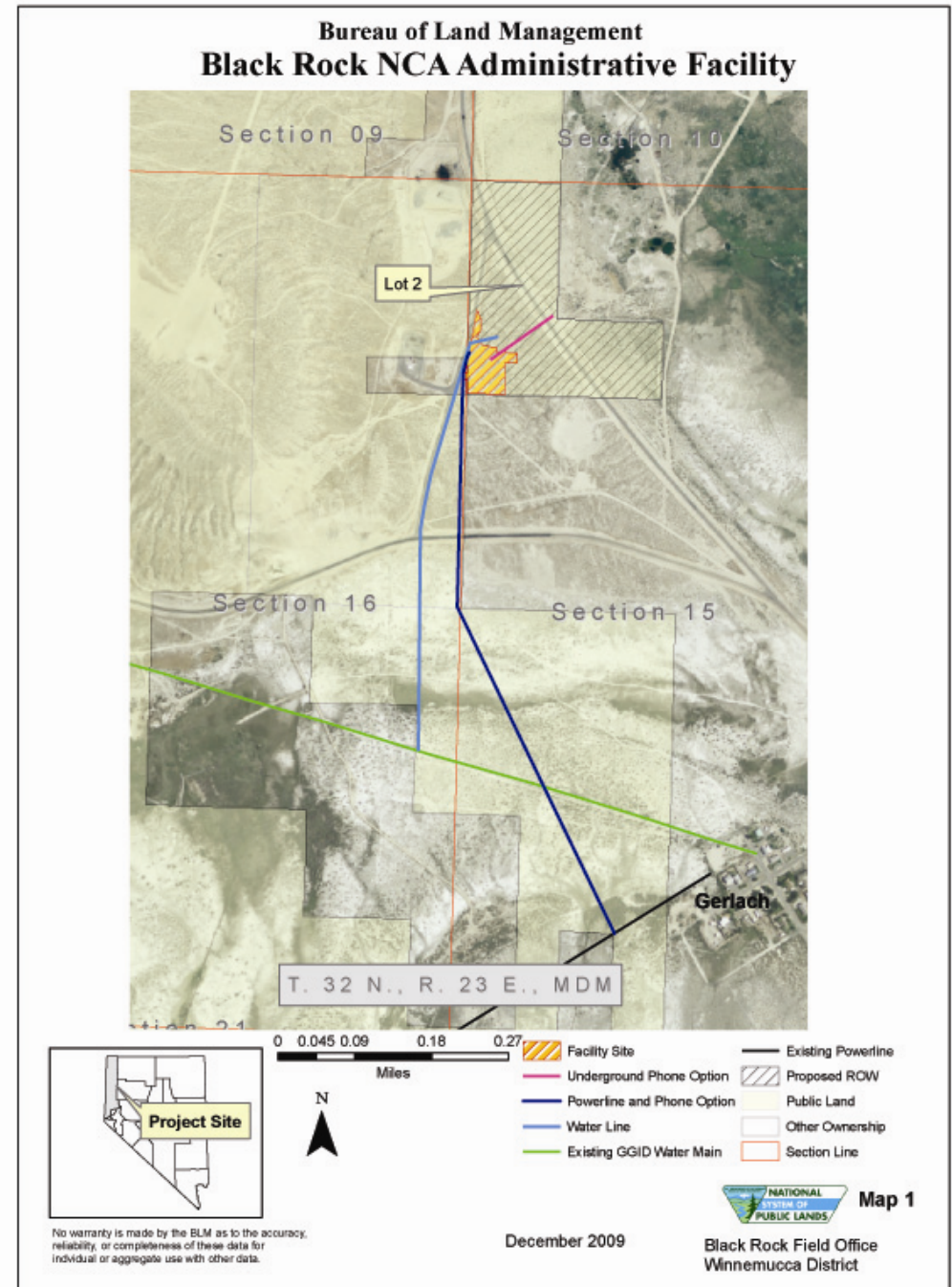

Black Rock NCA Administrative Facility Site Plan

